

UScreen® Cup

Urine Drug Screen Procedure

For detailed instructions, please read the package insert.

Kit Contents

- 25 UScreen® Cup Test Devices
- 1 Package Insert
- 1 Adulteration Color Comparison Chart
- 25 Security Seals

Store at 4-30°C (39-86°F) in the original sealed pouch. Do not freeze.

Cup Components

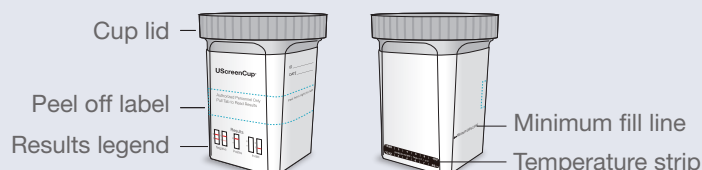

Collection and Testing Procedure

1 Collect sample and attach lid.

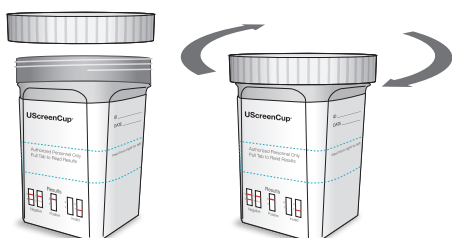

2 Verify the urine temperature is within acceptable range of 32-38°C (90-100°F).



3 Peel back label to reveal results.

Adulteration test results

Adulteration on test result (if applicable)

If your cup is equipped with adulterant pads, verify that pad colors are within acceptable range according to the adulteration guide.

Adulterant	Color	Acceptable Range
Glucose	Yellow	Yellow
Bilirubin	Yellow	Yellow
Urobilinogen	Yellow	Yellow
Urobilin	Yellow	Yellow
Uroporphyrinogen	Yellow	Yellow
Uroporphyrin	Yellow	Yellow
Uroporphyrinogen	Yellow	Yellow
Uroporphyrin	Yellow	Yellow
Uroporphyrinogen	Yellow	Yellow
Uroporphyrin	Yellow	Yellow

For illustrative purposes only. Please refer to color comparison chart included with kit.

Adulteration color chart

4 Wait 5 minutes, and read drug test result.

Drug test result interpretation

Drug test result area

Negative Preliminary Positive Invalid

Laboratory Confirmation

Preliminary positive drug test results

Apply security seal to preliminary positive specimens being sent for lab confirmation.

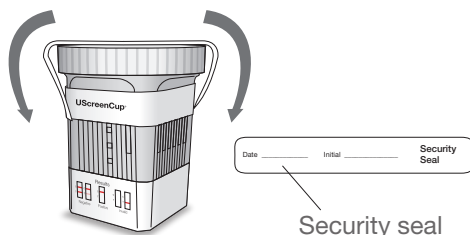

This assay provides only a preliminary analytical test result. A more specific alternative chemical method must be used in order to obtain a confirmed analytical result. Gas chromatography-mass spectrometry (GC-MS) and liquid chromatography-tandem mass spectrometry (LC-MS/MS) are the preferred confirmatory methods. Clinical consideration and professional judgment should be applied to any drug test result, particularly when preliminary positive results are indicated.



Distributed By: Blue Grass Drug Screen, Inc. www.usscreeningssource.com Toll Free 1-866-323-7336
Manufactured for Alere Toxicology Services – Products Division

© 2018 Alere. All rights reserved. The Alere Logo, Alere, and Uscreen Cup are trademarks of the Alere group of companies. Intended for in vitro diagnostic use.